

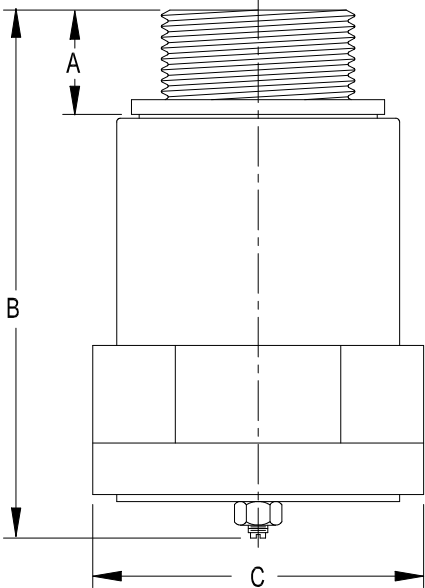

PPV VENT

FOR DOT406 TANKS

A normal vent designed for use on DOT406 cargo tanks. The pressure setting of "no less than 1 PSIG" per 178.346-10 (2) and a vacuum setting of 6 oz. Allow for efficient recovery of vapors during closed system loading and off-loading. Vent is flow tested and marked. NOTE: This vent will not provide sufficient venting for product discharge.



	Thru Area	Capacity
Inbreathing	1.25 sq. in.	3350 cu. ft. hr. @ 1 PSIG
Outbreathing	0.44 sq. in.	1200 cu. ft. hr. @ 3 PSIG

* Note: Unique design retains product at any attitude of rollover.

Material			Thread Size	Dimensions			Wt.	Symbol*	Assembly No.
Body	Disc	Trim		A	B	C			
Aluminum	Buna	316 Stnls.	1 ⁵ / ₈ -12	7/ ₈	4 ⁷ / ₁₆	2 ³ / ₄	1.2LB.	PPV	6496AL

* Note: Symbols are used ONLY in connection with COMPLETE MANHOLE ASSEMBLIES.

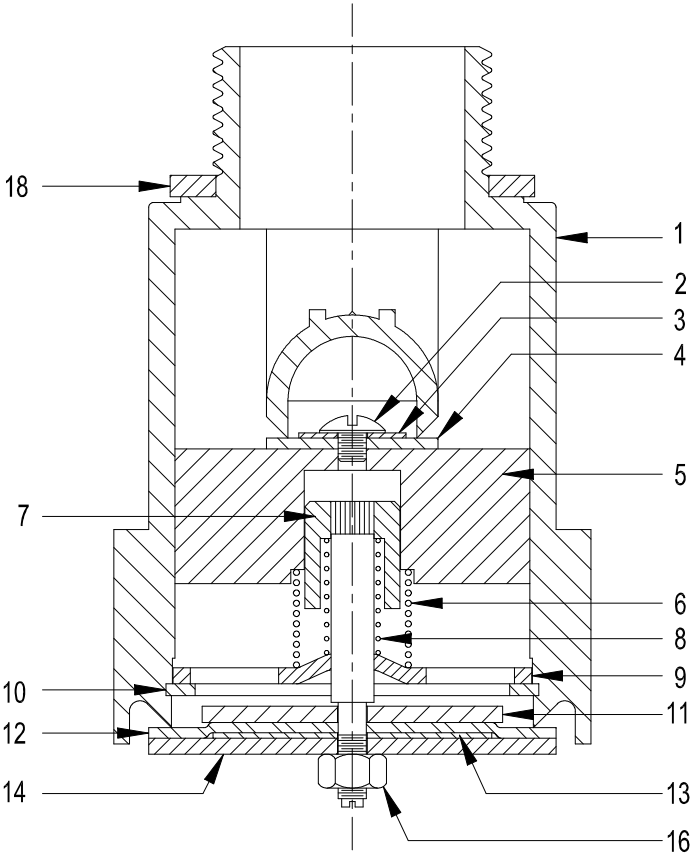

PARTS LIST

No.	Req.	Part No.	Description
1	1	6253AL	Body
2	1	9Q8216	#8-32 Truss Hd. Mach. Screw
3	1	3645NY	Pressure Disc Retainer Washer
4	1	3644BN	Pressure Disc
5	1	3640SL	Roll-Over Guide Block
6	1	3812SL	Pressure Relief Spring
7	1	3643SL	Spring Collar Assembly
8	1	3653SL	Vacuum Relief Spring
9	1	3649AL	Retainer Plate
10	1	9Q8206	Retaining Ring
11	1	3647AL	Vacuum Disc Retainer Washer
12	1	3646BN	Vacuum Disc
13	1	3675NY	Vacuum Spacer Washer
14	1	3969AL	Vacuum Disc Support & Rating Plate
16	1	9Q8220	Hex. Nut with Nylon insert #8-32 Thd.
18	1	3716BN	Buna Washer