

Vent Accessories

EMISSION COLLECTION HOOD

Use with Betts Push Type
or Air Operated Vents

ATTACHES TO POSITIVE VENT

MOLDED URETHANE

VERSATILE

QUICK REMOVABLE

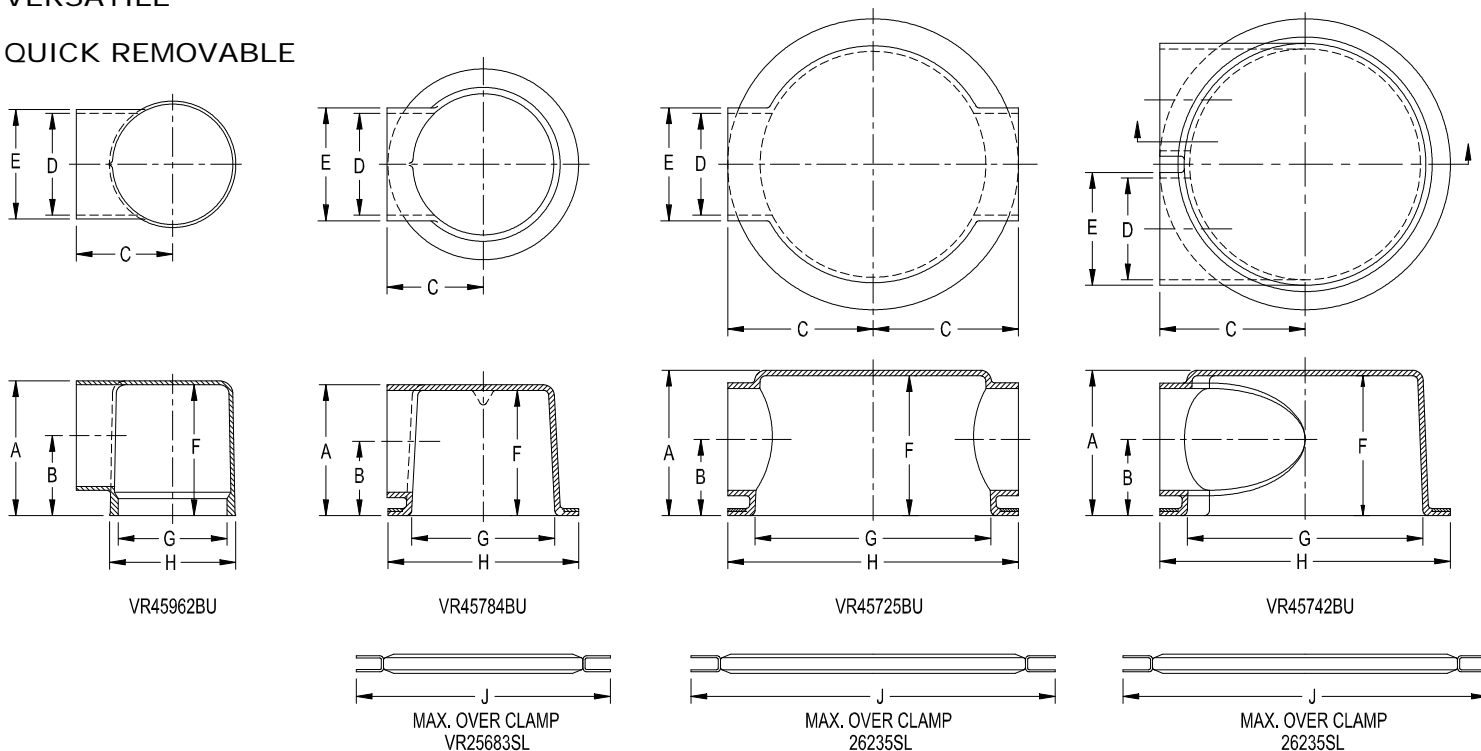

The Betts emission collection hood provides an economical means of collecting the vapors generated while filling the tank. The hood is designed to collapse in case of rollover without adversely affecting the product retention of the cargo tank.

Large hoods with two outlets are provided with end cap for lugging one outlet, if necessary.

NOTE: Effective protection against overfilling should be provided.

*To order hood assemblies less mounting clamp, add suffix "001" to assembly number.

Example: VR45725BU001

DIMENSIONS

MODEL	A	B	C	D	E	F	G	H	J
45742	5	2 ⁵ / ₈	5	3 ¹ / ₂	3 ⁷ / ₈	4 ¹³ / ₁₆	8 ¹ / ₈	10	12 ¹ / ₄
45725	5	2 ⁵ / ₈	5	3 ¹ / ₂	3 ⁷ / ₈	4 ¹³ / ₁₆	8 ¹ / ₈	10	12 ¹ / ₄
45784	4 ¹ / ₂	2 ⁹ / ₁₆	3 ³ / ₈	3 ¹ / ₂	3 ⁷ / ₈	4 ⁵ / ₁₆	4 ¹⁵ / ₁₆	6 ⁵ / ₈	8 ³ / ₄
45962	4 ⁵ / ₈	2 ¹ / ₈	3 ⁵ / ₁₆	3 ⁹ / ₁₆	3 ¹³ / ₁₆	4 ¹ / ₂	3 ¹³ / ₁₆	4 ⁵ / ₁₆	----

Description	Material	Wt.	Assembly No.
Two Outlets – 180° Apart	Urethane	3.5	VR45725BU
Two Outlets – Same Side			VR45742BU
Includes mounting clamp 26235SL, two outlet clamp 17191SL, and coupling cap 16968AL, and one coupling 16451AL.			
These hoods designed for 5" vents.			
NOTE: Mounting flange may be drilled to fit the bolt circle of other vents.			
One Outlet (small size)	Urethane	2.1	VR45784BU
Includes mounting clamp VR25683SL, outlet clamp 17191SL, and coupling 16451AL.			
This hood designed for 3½" bolted style vents.			
One Outlet (small size)	Urethane	1	VR45962BU
Indicates mounting clamp 17630SL, outlet clamp 17191, and coupling 16451AL.			